

# Canon® EF/EF-S Lens Controller

(Product ID: Controller: LC-2, Adapters: LC-2A-C, LC-2A-M42, LC-2A-T)

The Canon® EF/EF-S Lens Controller is small and compact and can operate most Canon® (USM) and Tamron® (USD) EF/EF-S lenses including L series and IS/VC models. The Ethernet connection makes communication much simpler than traditional serial lens controllers and also allows it to be operated over a longer distances.



<b>Compatibility</b>	Remotely control Canon® and Tamron® EF/EF-S auto focus (AF) lenses	Adapters for c-, M42x1- and T-mount cameras.
<b>Control</b>	Auto-detection of attached lens and F-number	Accurate control of Focus, and aperture and image stabilization
<b>Networking</b>	Multiple devices can be connected and simultaneously controlled over a network	10/100 Mbps Ethernet
<b>Versatility</b>	Unlimited programmable preset capability to easily store and recall saved positions on the lens	Easy to use software interface or TCP/IP API commands



LC-2 (Control Box)



LC-2A-C (C-Mount Lens Adapter)



LC-2A-M42 (M42x1-Mount Lens Adapter)

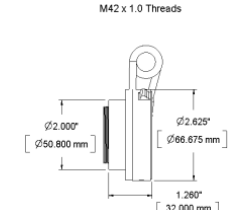
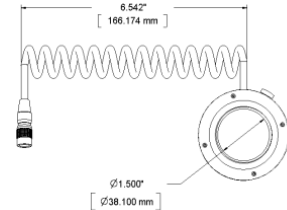
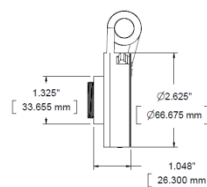
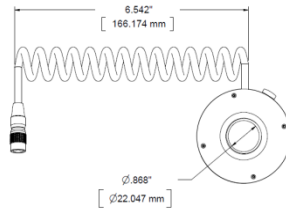
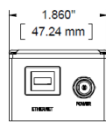
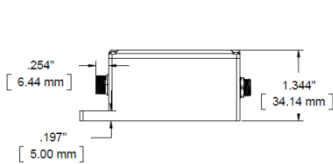

## SPECIFICATIONS

<b>Power</b>	100-240 V, 50-60Hz
<b>Input</b>	6V --- 1.5A
<b>Operating Temperature</b>	2-60 °C
<b>Interface</b>	10/100 Mbps Ethernet
<b>Lens Adapter</b>	M42, c, T (customization available)
<b>Lens inputs</b>	1
<b>Presets</b>	Unlimited, programmable
<b>Software</b>	Windows GUI, TCP/IP API
<b>ECCN</b>	EAR99

Innovative Scientific Solutions, Inc.  
7610 McEwen Road, Dayton, OH 45459  
Phone (937) 630-3012 Fax (937) 630-3015

email: [issj-sales@innssi.com](mailto:issj-sales@innssi.com)  
web: [www.psp-tsp.com](http://www.psp-tsp.com)

Any and all underlying information and technology contained in this document may be subject to U.S. export controls, including the Export Administration Act (50 U.S.C. Appx. §§ 2401 et seq.) and the Export Administration Regulations ("EAR", 50 C.F.R. Parts 730-774), and may be subject to export or import regulations in other countries. You are responsible for complying with all trade regulations and laws both foreign and domestic. Except as authorized by law or distributor agreement with ISSI, you agree and warrant not to export or re-export the information to any country, or to any person, entity, or end-user subject to U.S. export controls, including without limitation persons or entities listed on the U.S. Department of Commerce Bureau of Export Administration's Denied Parties List and the U.S. Department of Treasury's Specially Designated Nationals. You further represent and warrant that no U.S. federal agency has suspended, revoked, or denied your export privileges. CANON® is a registered trademark of Canon, Inc.