

LM2XX-DM LED Light Source

(Product ID: LM2XX-DM-400, LM2XX-DM-460)

The LM2XX-DM is a 2-inch, water-cooled LED light source that provides uniform, stable illumination, for Pressure and Temperature Sensitive Paint measurements. The unit is designed for radiometric systems by connecting to the DM driver box (module for radiometric). The LM2XX-DM can operate continuously or in long-pulse mode. The operation mode is set using an external toggle switch on the DM module. Pulse mode operation is controlled by applying a TTL voltage to the external BNC on the DM module. In this mode the rise and fall times are less than 1- μ s and the duty cycle may be set from 0% to 100%. The light distribution from the unit is approximately Gaussian for distance greater than 18-inches [45-cm] from the source. The units are available in 400-nm and 460-nm packages, however, other wavelenths are available upon request. This unit surpasses the performance of an LM2X-DM air-cooled system as it offers a significant increase in power (3-4 times that of an LM2X-DM). Maximum input pressure to the control box is 90 psi.



LM2XX-DM components: LED head, umbilical, and control box.

SPECIFICATIONS

Output power	~ 10-12 W
Stability.....	~0.1 % per hour after warm-up
Maximum duty cycle	100%
Rise time (10% - 90%)	< 600-ns
Fall time (90% - 10%)	< 300-ns
Operating temperature range	-10°C to 60°C
Wavelength.....	400-nm and 460-nm
FWHM.....	+/-18-nm
Umbilical Cable.....	10-ft (3.3m) / 20-ft (6.6m)
Warranty	1 Year
ECCN	EAR99

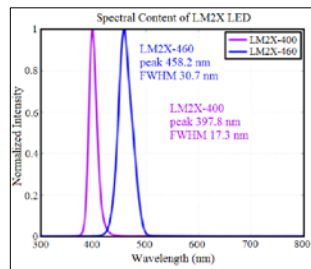
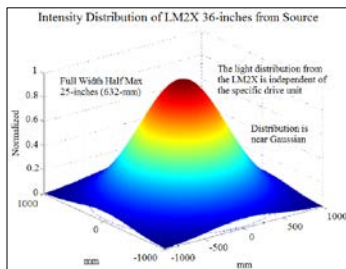

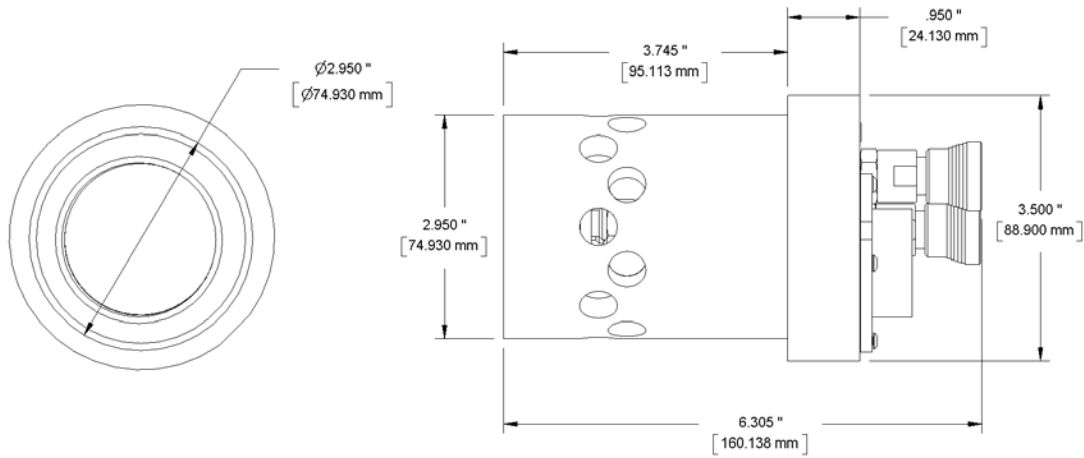

LED Head

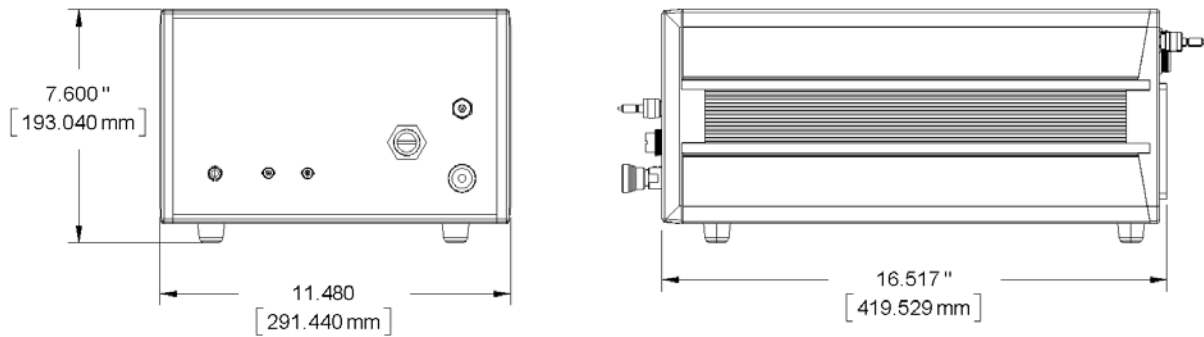

LED Control Box and Power Supply